

DP-10 HALF DAMPER PEDAL Owner's Manual

Thank you, and congratulations on your choice of the Roland DP-10 Half Damper Pedal. The DP-10 pedal controls the half damper function, a must for authentic piano performances. You can use the pedal after connecting it to a Roland digital piano.





Before using this unit, carefully read the sections entitled: "USING THE UNIT SAFELY" and "IMPORTANT NOTES". These sections provide important information concerning the proper operation of the unit. Additionally, in order to feel assured that you have gained a good grasp of every feature provided by your new unit, owner's manual should be read in its entirety. The manual should be saved and kept on hand as a convenient reference.

Copyright © 2004 ROLAND CORPORATION

All rights reserved. No part of this publication may be reproduced in any form without the written permission of ROLAND CORPORATION.

■ USING THE UNIT SAFELY

⚠ WARNING

- Do not attempt to repair the unit, or replace parts within it (except when this manual provides specific instructions directing you to do so). Refer all servicing to your retailer, the nearest Roland Service Center, or an authorized Roland distributor, as listed on the "Information" page. 
- Do not allow any objects (e.g., flammable material, coins, pins); or liquids of any kind (water, soft drinks, etc.) to penetrate the unit. 

- In households with small children, an adult should provide supervision until the child is capable of following all the rules essential for the safe operation of the unit. 

■ IMPORTANT NOTES

- Do not expose the unit to direct sunlight, place it near devices that radiate heat, leave it inside an enclosed vehicle, or otherwise subject it to temperature extremes. Excessive heat can deform or discolor the unit.
- For everyday cleaning wipe the unit with a soft, dry cloth or one that has been slightly dampened with water. To remove stubborn dirt, use a cloth impregnated with a mild, non-abrasive detergent. Afterwards, be sure to wipe the unit thoroughly with a soft, dry cloth.
- When connecting / disconnecting all cables, grasp the connector itself—never pull on the cable. This way you will avoid causing shorts, or damage to the cable's internal elements.

■ Features

Function Switch

You can select the function appropriate for the application you have in mind for the pedal.

○ Half Damper Control

This allows you to perform using the half damper function.

○ Switch Control

The pedal functions as a pedal switch, just like the Roland DP-2 and DP-6.

Use the function switch on the side of the pedal to select the function you want to use.

Rubber Plate

By holding the pedal firmly in place and preventing it from sliding around, this plate makes it easier to depress the pedal reliably and effectively.

■ Panel Descriptions

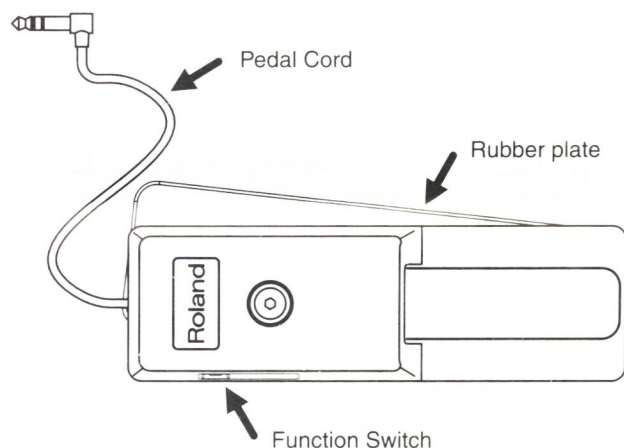

■ Connecting the Pedal

- 1 Connect the pedal's cord to the Damper Pedal jack (or other Pedal jack) of the device to which the pedal is being connected.

* Note that connecting to any connector other than those specified above may result in damage to the unit.

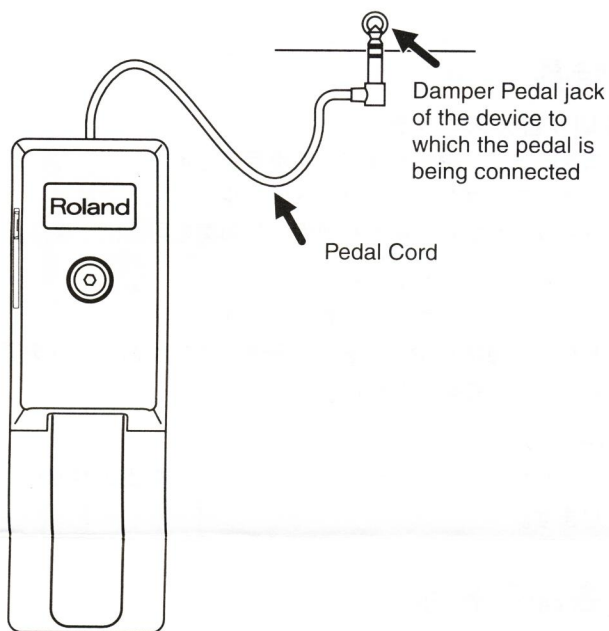

- 2 Set the DP-10's function switch to "Continuous."

* With instruments that do not support the use of the half damper function, the pedal may not function as hoped for. Should this be the case, move the DP-10's function switch to the "Switch" position.

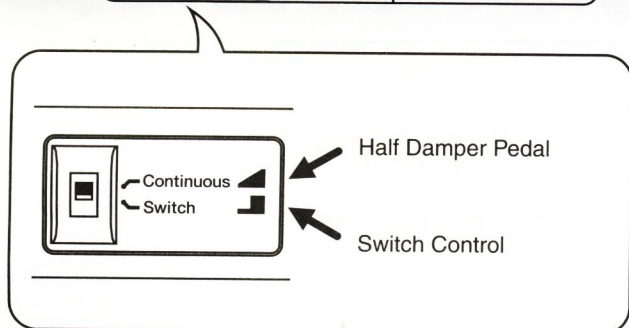
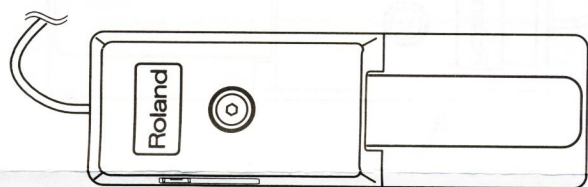

- 3 Rotate the rubber plate 180 degrees clockwise to install it on the floor.

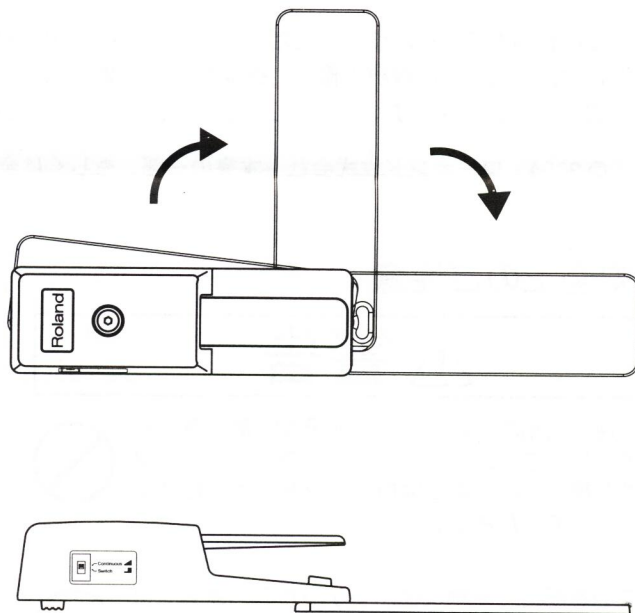

■ Main Specifications

- Pedal Cord
2.2 m
- Function Switch
Continuous/Switch
- Dimensions
68 (W) x 220 (D) x 64 (H) mm
2-11/16" (W) x 8-11/16" (D) x 2-9/16" (H) inch
When using the rubber plate
68 (W) x 402 (D) x 64 (H) mm
2-11/16" (W) x 15-7/8" (D) x 2-9/16" (H) inch
- Weight
0.7 kg
1 lb 9 oz

* In the interest of product improvement, the specifications and/or appearance of this unit are subject to change without prior notice.

For information about the effects produced when you operate the pedal, please refer to the documentation for the connected device.